

Snapfix Standard

Nyudviklet, patenteret hurtigmontagesystem til rørgvindinstallationer med høj udrivningsbestandighed. Montage af tilslutningsstykker sker kun uden for huset. Der kræves ingen gevind i huset og ingen kontramøtrik.

Montagevejledning fra side 165.

| | |
|---------------------------|--|
| Snapcllic | Slangeforskruning med gevind eller til indstik, for skabstykkelser 1 – 3 mm |
| Snapcllic DUO | Snapcllic DUO – flexslange forskruning med indvendig pakning og kabelaflastning, for skabstykkelser 1 – 3 mm |
| Snapcllic-PA-W | Vinkelforskruninger til rillet rør |
| Snapcllic-DUO-PA-W | Vinkelforskruning til bølgerør med ekstra pakning og trækaflastning |
| Snapfix | Slangeforskruning i polyamid, for skabstykkelser 1 – 3 mm |
| Snapflex | Flexslange i polyamid, passer til Snapcllic og Snapdor |
| Snapclip | Slangeholder for Snapflex i polyamid, kan sættes i rækker eller stables |
| Snapform | Vinkel for flexslange |
| Snapsplit | Slangeforskruning med Y- og T-stykke |



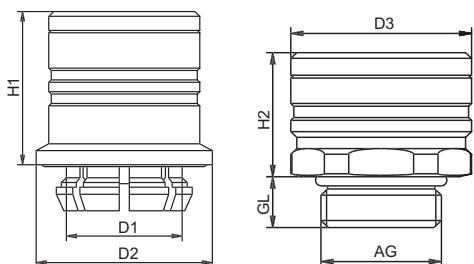

Materiale PA
 O-ring NBR
 Omgivelses-temperatur -40 °C – 100 °C
 Farver sort / grå



NPT- og langt gevind på forespørgsel

| AG | GL mm | SW mm | D1 mm | D2 mm | D3 mm | H1 mm | H2 mm | Passer til Snapflex | Best.-Nr. | Passer til SM-WS | Best.-Nr. |
|--|----------|----------|----------|----------|----------|----------|----------|------------------------|---------------|---------------------|---------------|
| Snapclic med indskruningsenhed | | | | | | | | | | | |
| | | | 20 | 30 | | 29 | | | | DN 10 | 1.540.1000.50 |
| | | | 20 | 30 | | 31 | | 16 | 1.540.1600.50 | DN 12 | 1.540.1200.50 |
| | | | 25 | 35 | | 32 | | | | DN 14 | 1.540.1400.50 |
| | | | 25 | 35 | | 33 | | 20 | 1.540.2000.50 | DN 17 | 1.540.1700.50 |
| | | | 32 | 42 | | 34 | | 25 | 1.540.2500.50 | DN 23 | 1.540.2300.50 |
| | | | 40 | 50 | | 36 | | 32 | 1.540.3200.50 | | |
| | | | 50 | 60 | | 37 | | 40 | 1.540.4000.50 | DN 37 | 1.540.3700.50 |
| Snapclic med metrisk tilslutningsgevind | | | | | | | | | | | |
| M 16 x 1,5 | 9 | 22 | | | 23 | | 18 | | | DN 10 | 1.541.1610.55 |
| M 16 x 1,5 | 9 | 24 | | | 25 | | 20 | 16 | 1.541.1600.50 | DN 12 | 1.541.1612.55 |
| M 20 x 1,5 | 9 | 28 | | | 30 | | 22 | 20 | 1.541.2000.50 | DN 14 | 1.541.2014.55 |
| M 20 x 1,5 | 9 | 28 | | | 30 | | 22 | | | DN 17 | 1.541.2017.55 |
| M 25 x 1,5 | 11 | 33 | | | 35 | | 23 | 25 | 1.541.2500.50 | DN 17 | 1.541.2517.55 |
| M 32 x 1,5 | 11 | 37 | | | 44 | | 25 | 32 | 1.541.3200.50 | DN 23 | 1.541.3223.55 |
| M 40 x 1,5 | 13 | 50 | | | 52 | | 26 | 40 | 1.541.4000.50 | DN 29 | 1.541.4029.55 |
| PG 11 | 9 | 22 | | | 23 | | 18 | | | DN 10 | 1.541.1110.02 |
| PG 11 | 9 | 24 | | | 25 | | 20 | 16 | 1.541.1116.14 | DN 12 | 1.541.1112.02 |
| PG 13,5 | 9 | 28 | | | 30 | | 22 | 20 | 1.541.1320.14 | DN 14 | 1.541.1314.02 |
| PG 16 | 9 | 28 | | | 30 | | 22 | | | DN 17 | 1.541.1617.02 |
| PG 21 | 11 | 33 | | | 35 | | 23 | 25 | 1.541.2125.14 | DN 17 | 1.541.2117.02 |
| PG 29 | 11 | 37 | | | 44 | | 25 | 32 | 1.541.2932.14 | DN 23 | 1.541.2923.02 |
| PG 36 | 13 | 50 | | | 52 | | 26 | 40 | 1.541.3640.14 | DN 29 | 1.541.3629.02 |

➔ Montagevejledning
side 170



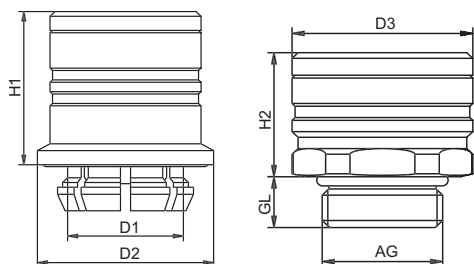

Materiale
Omgivelses-
temperatur

Forniklet messing / PA
-40 °C – 100 °C

NPT- og langt gevind på forespørgsel



| AG | GL mm | SW mm | D1 mm | D2 mm | D3 mm | H1 mm | H2 mm | Passer til Snapflex | Best.-Nr. | Passer til SM-WS | Best.-Nr. |
|--|----------|----------|----------|----------|----------|----------|----------|------------------------|---------------|---------------------|---------------|
| Snapclic med indskruningsenhed | | | | | | | | | | | |
| | | | 20 | 30 | | 29 | | | | DN 10 | 1.545.1000.50 |
| | | | 20 | 30 | | 31 | | 16 | 1.545.1600.50 | DN 12 | 1.545.1200.50 |
| | | | 25 | 35 | | 32 | | 20 | 1.545.2000.50 | DN 14 | 1.545.1400.50 |
| | | | 25 | 35 | | 33 | | | | DN 17 | 1.545.1700.50 |
| | | | 32 | 42 | | 34 | | 25 | 1.545.2500.50 | DN 23 | 1.545.2300.50 |
| | | | 40 | 50 | | 36 | | 32 | 1.545.3200.50 | DN 29 | 1.545.2900.50 |
| | | | 50 | 60 | | 37 | | 40 | 1.545.4000.50 | DN 37 | 1.545.3700.50 |
| Snapclic med metrisk tilslutningsgevind | | | | | | | | | | | |
| M 16 x 1,5 | 6 | 20 | | | 25 | | 20 | | | DN 10 | 1.546.1610.55 |
| M 16 x 1,5 | 6 | 22 | | | 25 | | 19 | 16 | 1.546.1600.50 | DN 12 | 1.546.1612.55 |
| M 20 x 1,5 | 6 | 24 | | | 30 | | 21 | 20 | 1.546.2000.50 | DN 14 | 1.546.2014.55 |
| M 20 x 1,5 | 6 | 24 | | | 30 | | 22 | | | DN 17 | 1.546.2017.55 |
| M 25 x 1,5 | 7 | 30 | | | 35 | | 22 | 25 | 1.546.2500.50 | DN 17 | 1.546.2517.55 |
| M 32 x 1,5 | 8 | 40 | | | 44 | | 25 | 32 | 1.546.3200.50 | DN 23 | 1.546.3223.55 |
| M 40 x 1,5 | 8 | 50 | | | 55 | | 26 | 40 | 1.546.4000.50 | DN 29 | 1.546.4029.55 |
| PG 11 | 6 | 20 | | | 25 | | 20 | 16 | | DN 10 | 1.546.1110.02 |
| PG 11 | 6 | 22 | | | 25 | | 20 | 16 | 1.546.1116.01 | DN 12 | 1.546.1112.02 |
| PG 13,5 | 6 | 24 | | | 25 | | 19 | 20 | 1.546.1320.01 | DN 14 | 1.546.1314.02 |
| PG 29 | 8 | 40 | | | 44 | | 25 | 32 | 1.546.2932.01 | DN 23 | 1.546.2923.02 |

➔ Montagevejledning
side 170



Snapclic-DUO-PA

Metr./PG

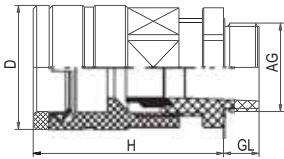

Materiale PA
 Pakning NBR
 Omgivelses-temperatur -40 °C – 100 °C



NPT- og langt tilslutningsgevind på forespørgsel

| AG | GL mm | H mm | D mm | Ø mm | Ø mm | Passer til Snapflex | Best.-Nr. | Ø mm | Passer til SM-WS | Best.-Nr. |
|------------|----------|---------|---------|---------|---------|------------------------|---------------|---------|---------------------|---------------|
| M 16 x 1,5 | 8 | 42 | 25 | 22 | 5 - 10 | 16 | 1.542.1601.50 | 5 - 10 | DN 10 | 1.542.1610.50 |
| M 16 x 1,5 | 8 | 42 | 25 | 22 | 3 - 7 | 16 | 1.542.1601.51 | 3 - 7 | DN 10 | 1.542.1610.51 |
| M 20 x 1,5 | 9 | 44 | 25 | 24 | | | | 6 - 12 | DN 12 | 1.542.2012.50 |
| M 20 x 1,5 | 9 | 44 | 25 | 24 | | | | 5 - 9 | DN 12 | 1.542.2012.51 |
| M 20 x 1,5 | 10 | 46 | 30 | 27 | 10 - 14 | 20 | 1.542.2001.50 | 10 - 14 | DN 14 | 1.542.2014.50 |
| M 20 x 1,5 | 10 | 46 | 30 | 27 | 7 - 12 | 20 | 1.542.2001.51 | 7 - 12 | DN 14 | 1.542.2014.51 |
| M 25 x 1,5 | 11 | 50 | 35 | 33 | 13 - 18 | 25 | 1.542.2501.50 | 13 - 16 | DN 17 | 1.542.2517.50 |
| M 25 x 1,5 | 11 | 50 | 35 | 33 | 9 - 16 | 25 | 1.542.2501.51 | 9 - 16 | DN 17 | 1.542.2517.51 |
| M 32 x 1,5 | 11 | 60 | 42 | 42 | 18 - 24 | 32 | 1.542.3201.50 | 18 - 22 | DN 23 | 1.542.3223.50 |
| M 32 x 1,5 | 11 | 60 | 42 | 42 | 13 - 20 | 32 | 1.542.3201.51 | 13 - 20 | DN 23 | 1.542.3223.51 |
| M 40 x 1,5 | 13 | 60 | 50 | 53 | 22 - 31 | 40 | 1.542.4001.50 | 22 - 28 | DN 29 | 1.542.4029.50 |
| M 40 x 1,5 | 13 | 60 | 50 | 53 | 20 - 26 | 40 | 1.542.4001.51 | 20 - 26 | DN 29 | 1.542.4029.51 |
| PG 11 | 8 | 42 | 25 | 22 | 5 - 10 | 16 | 1.543.1116.14 | 5 - 10 | DN 10 | 1.543.1110.14 |
| PG 11 | 8 | 42 | 25 | 22 | 3 - 7 | 16 | 1.543.1116.15 | 3 - 7 | DN 10 | 1.543.1110.15 |
| PG 13,5 | 9 | 44 | 25 | 24 | | | | 6 - 12 | DN 12 | 1.543.1312.14 |
| PG 13,5 | 9 | 44 | 25 | 24 | | | | 5 - 9 | DN 12 | 1.543.1312.15 |
| PG 16 | 10 | 46 | 30 | 27 | 10 - 14 | 20 | 1.543.1620.14 | 10 - 14 | DN 14 | 1.543.1614.14 |
| PG 16 | 10 | 46 | 30 | 27 | 7 - 12 | 20 | 1.543.1620.15 | 7 - 12 | DN 14 | 1.543.1614.15 |
| PG 21 | 11 | 50 | 35 | 33 | 13 - 16 | 25 | 1.543.2125.14 | 13 - 16 | DN 17 | 1.543.2117.14 |
| PG 21 | 11 | 50 | 35 | 33 | 9 - 16 | 25 | 1.543.2125.15 | 9 - 16 | DN 17 | 1.543.2117.15 |
| PG 29 | 11 | 60 | 42 | 42 | 18 - 22 | 32 | 1.543.2932.14 | 18 - 22 | DN 23 | 1.543.2923.14 |
| PG 29 | 11 | 60 | 42 | 42 | 13 - 20 | 32 | 1.543.2932.15 | 13 - 20 | DN 23 | 1.543.2923.15 |
| PG 36 | 13 | 60 | 50 | 53 | 22 - 28 | 40 | 1.543.3640.14 | 22 - 28 | DN 29 | 1.543.3629.14 |
| PG 36 | 13 | 60 | 50 | 53 | 20 - 16 | 40 | 1.543.3640.15 | 20 - 26 | DN 29 | 1.543.3629.15 |



Snapclic-DUO-MS

Metr./PG

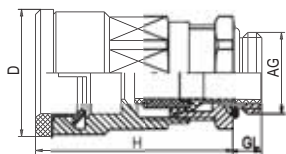

Materiale
Klemmeindsats
Pakning
Omgivelses-
temperatur

Forniklet messing
PA
NBR
-40 °C – 100 °C



NPT- og langt gevind på forespørgsel
Fås også som EMC-variant!

| AG | GL mm | H mm | D mm | Ø mm | Ø mm | Passer til Snapflex | Best.-Nr. | Ø mm | Passer til SM-WS | Best.-Nr. |
|------------|----------|---------|---------|---------|---------|------------------------|---------------|---------|---------------------|---------------|
| M 16 x 1,5 | 6 | 38,5 | 23 | 20 | 5 - 10 | 16 | 1.547.1601.50 | 5 - 10 | 10 | 1.547.1610.50 |
| M 16 x 1,5 | 6 | 38,5 | 23 | 20 | 3 - 7 | 16 | 1.547.1601.51 | 3 - 7 | 10 | 1.547.1610.51 |
| M 20 x 1,5 | 6 | 39,5 | 25 | 22 | | | | 6 - 12 | 12 | 1.547.2012.50 |
| M 20 x 1,5 | 6 | 39,5 | 25 | 22 | | | | 5 - 9 | 12 | 1.547.2012.51 |
| M 20 x 1,5 | 6 | 41,5 | 29 | 24 | 10 - 14 | 20 | 1.547.2001.50 | 10 - 14 | 14 | 1.547.2014.50 |
| M 20 x 1,5 | 6 | 41,5 | 29 | 24 | 7 - 12 | 20 | 1.547.2001.51 | 7 - 12 | 14 | 1.547.2014.51 |
| M 25 x 1,5 | 7 | 44,5 | 30 | 30 | 13 - 18 | 25 | 1.547.2501.50 | 13 - 16 | 17 | 1.547.2517.50 |
| M 25 x 1,5 | 7 | 44,5 | 30 | 30 | 9 - 16 | 25 | 1.547.2501.51 | 9 - 16 | 17 | 1.547.2517.51 |
| M 32 x 1,5 | 8 | 52,5 | 39 | 40 | 18 - 24 | 32 | 1.547.3201.50 | 18 - 22 | 23 | 1.547.3223.50 |
| M 32 x 1,5 | 8 | 52,5 | 39 | 40 | 13 - 20 | 32 | 1.547.3201.51 | 13 - 20 | 23 | 1.547.3223.51 |
| M 40 x 1,5 | 8 | 59 | 45 | 50 | 22 - 31 | 40 | 1.547.4001.50 | 22 - 28 | 29 | 1.547.4029.50 |
| M 40 x 1,5 | 8 | 59 | 45 | 50 | 20 - 26 | 40 | 1.547.4001.51 | 20 - 26 | 29 | 1.547.4029.51 |
| PG 11 | 6 | 38,5 | 23 | 20 | 5 - 10 | 16 | 1.548.1116.01 | 5 - 10 | 10 | 1.548.1110.01 |
| PG 11 | 6 | 38,5 | 23 | 20 | 3 - 7 | 16 | 1.548.1116.15 | 3 - 7 | 10 | 1.548.1110.15 |
| PG 13,5 | 6 | 39,5 | 25 | 22 | | | | 6 - 12 | 12 | 1.548.1312.01 |
| PG 13,5 | 6 | 39,5 | 25 | 22 | | | | 5 - 9 | 12 | 1.548.1312.15 |
| PG 16 | 6 | 41,5 | 29 | 24 | 10 - 14 | 20 | 1.548.1620.01 | 10 - 14 | 14 | 1.548.1614.01 |
| PG 16 | 6 | 41,5 | 29 | 24 | 7 - 12 | 20 | 1.548.1620.15 | 7 - 12 | 14 | 1.548.1614.15 |
| PG 21 | 7 | 44,5 | 30 | 30 | 13 - 16 | 25 | 1.548.2125.01 | 13 - 16 | 17 | 1.548.2117.01 |
| PG 21 | 7 | 44,5 | 30 | 30 | 9 - 16 | 25 | 1.548.2125.15 | 9 - 16 | 17 | 1.548.2117.15 |
| PG 29 | 8 | 52,5 | 39 | 40 | 18 - 22 | 32 | 1.548.2932.01 | 18 - 22 | 23 | 1.548.2923.01 |
| PG 29 | 8 | 52,5 | 39 | 40 | 13 - 20 | 32 | 1.548.2932.15 | 13 - 20 | 23 | 1.548.2923.15 |
| PG 36 | 8 | 59 | 45 | 50 | 22 - 28 | 40 | 1.548.3640.01 | 22 - 28 | 29 | 1.548.3629.01 |
| PG 36 | 8 | 59 | 45 | 50 | 20 - 16 | 40 | 1.548.3640.15 | 20 - 26 | 29 | 1.548.3629.15 |



Snapcllic-PA-W

Metr./PG/NPT

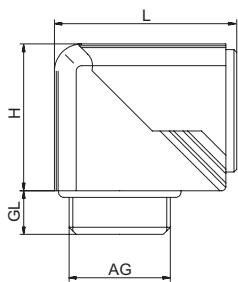

Materiale
O-ring
Omgivelses-
temperatur
Farver

PA
NBR

-20 °C – 80 °C
sort



| AG | GL mm | H mm | L mm | R mm | | | Passer til Snapflex | Best.-Nr. | Passer til SM-WS | Best.-Nr. |
|------------|----------|---------|---------|---------|----|----|------------------------|---------------|---------------------|---------------|
| M 20 x 1,5 | 9 | 30,5 | 38 | 7 | 7 | 24 | | | DN 10 | 1.552.2010.50 |
| M 25 x 1,5 | 11 | 40 | 53 | 10 | 10 | 33 | 20 | 1.552.2520.50 | DN 14 | 1.552.2514.50 |
| M 25 x 1,5 | 11 | 40 | 53 | 10 | 10 | 33 | 25 | 1.552.2525.50 | DN 17 | 1.552.2517.50 |
| M 32 x 1,5 | 11 | 51,5 | 64,5 | 14 | 14 | 42 | 32 | 1.552.3200.50 | DN 23 | 1.552.3223.50 |
| PG 13,5 | 9 | 30,5 | 38 | 25 | 7 | 24 | | | DN 10 | 1.552.1310.14 |
| PG 16 | 10 | 32,5 | 41,5 | 30 | 8 | 27 | 16 | 1.552.1616.14 | DN 12 | 1.552.1612.14 |
| PG 21 | 11 | 40 | 53 | 35 | 10 | 33 | 20 | 1.552.2120.14 | DN 14 | 1.552.2114.14 |
| PG 21 | 11 | 40 | 53,5 | 35 | 10 | 33 | 25 | 1.552.2125.14 | DN 17 | 1.552.2117.14 |
| PG 29 | 11 | 51,5 | 64,5 | 42 | 14 | 42 | 32 | 1.552.2932.14 | DN 23 | 1.552.2923.14 |
| 1/2" NPT | 13 | 30,5 | 38 | 25 | 7 | 24 | | | DN 10 | 1.552.1210.70 |
| 3/4" NPT | 13 | 40 | 53 | 35 | 10 | 33 | 20 | 1.552.3420.70 | DN 14 | 1.552.3414.70 |
| 3/4" NPT | 13 | 40 | 53,5 | 35 | 10 | 33 | 25 | 1.552.3425.70 | DN 17 | 1.552.3417.70 |
| 1" NPT | 19 | 51,5 | 64,5 | 42 | 14 | 42 | 32 | 1.552.1032.70 | DN 23 | 1.552.1023.70 |



Snapclic-DUO-PA-W

Metr./PG

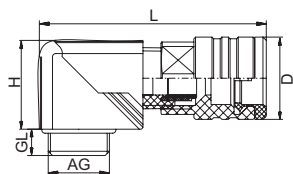

Materiale PA
 Pakning NBR
 Omgivelses-temperatur -20 °C – 80 °C



NPT- og langt gevind på forespørgsel

| AG | GL mm | H mm | L mm | D mm | R mm | Ø mm | Ø mm | Passer til Snapflex | Best.-Nr. | Ø mm | Passer til SM-WS | Best.-Nr. |
|------------|----------|---------|---------|---------|---------|---------|---------|------------------------|---------------|---------|---------------------|---------------|
| M 20 x 1,5 | 9 | 30,5 | 74,5 | 25 | 7 | 24 | | | | 6 - 12 | DN 10 | 1.554.2012.50 |
| M 20 x 1,5 | 9 | 30,5 | 74,5 | 25 | 7 | 24 | | | | 5 - 9 | DN 10 | 1.554.2012.51 |
| M 25 x 1,5 | 11 | 40 | 93 | 35 | 10 | 33 | 13 - 18 | 25 | 1.553.2501.50 | 13 - 16 | DN 14 | 1.554.2517.50 |
| M 25 x 1,5 | 11 | 40 | 93 | 35 | 10 | 33 | 9 - 16 | 25 | 1.553.2501.51 | 9 - 16 | DN 17 | 1.554.2517.51 |
| M 32 x 1,5 | 11 | 51,5 | 110,5 | 42 | 14 | 42 | 18 - 22 | 32 | 1.553.3201.50 | 18 - 22 | DN 23 | 1.554.3223.50 |
| M 32 x 1,5 | 11 | 51,5 | 110,5 | 42 | 14 | 42 | 13 - 20 | 32 | 1.553.3201.51 | 13 - 20 | DN 23 | 1.554.3223.51 |
| PG 11 | 8 | 27 | 66,5 | 25 | 6 | 22 | 5 - 10 | 16 | 1.554.1116.14 | 5 - 10 | DN 10 | 1.554.1110.14 |
| PG 11 | 8 | 27 | 66,5 | 25 | 6 | 22 | 3 - 7 | 16 | 1.554.1116.15 | 3 - 7 | DN 10 | 1.554.1110.15 |
| PG 13,5 | 9 | 30,5 | 74,5 | 25 | 7 | 24 | | | | 6 - 12 | DN 12 | 1.554.1312.14 |
| PG 13,5 | 9 | 30,5 | 74,5 | 25 | 7 | 24 | | | | 5 - 9 | DN 12 | 1.554.1312.15 |
| PG 16 | 10 | 32,5 | 78 | 30 | 8 | 27 | 10 - 14 | 20 | 1.554.1620.14 | 10 - 14 | DN 14 | 1.554.1614.14 |
| PG 16 | 10 | 32,5 | 78 | 30 | 8 | 27 | 7 - 12 | 20 | 1.554.1620.15 | 7 - 12 | DN 14 | 1.554.1614.15 |
| PG 21 | 11 | 40 | 93 | 35 | 10 | 33 | 13 - 16 | 25 | 1.554.2125.14 | 13 - 16 | DN 17 | 1.554.2117.14 |
| PG 21 | 11 | 40 | 93 | 35 | 10 | 33 | 9 - 16 | 25 | 1.554.2125.15 | 9 - 16 | DN 17 | 1.554.2117.15 |
| PG 29 | 11 | 51,5 | 110,5 | 42 | 14 | 42 | 18 - 22 | 32 | 1.554.2932.14 | 18 - 22 | DN 23 | 1.554.2923.14 |
| PG 29 | 11 | 51,5 | 110,5 | 42 | 14 | 42 | 13 - 20 | 32 | 1.554.2932.15 | 13 - 20 | DN 23 | 1.554.2923.15 |



Snapfix

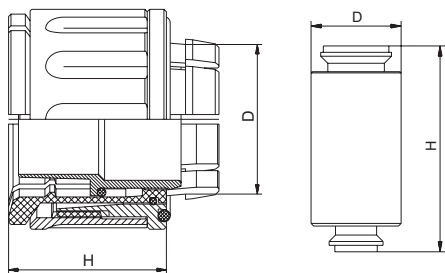

Materiale
Omgivelses-
temperatur
Farver

PA
-40 °C – 100 °C
sort / grå



Demontageværktøj for Snaptool-F

| Størrelse D | H mm | for pladetykkelse mm | Boring Ø mm | Passer til Snapflex | Best.-Nr. |
|-------------|------|----------------------|-------------|---------------------|---------------|
| 16 | 26,5 | 1 - 3 | 16 | 16 | 1.515.1600.50 |
| 20 | 29 | 1 - 3 | 20 | 20 | 1.515.2000.50 |
| 25 | 30,5 | 1 - 3 | 25 | 25 | 1.515.2500.50 |
| 32 | 33 | 1 - 3 | 32 | 32 | 1.515.3200.50 |
| 40 | 36 | 1 - 3 | 40 | 40 | 1.515.4000.50 |
| 50 | 40 | 1 - 3 | 50 | 50 | 1.515.5000.50 |
| 63 | 46 | 1 - 3 | 63 | 63 | 1.515.6300.50 |

| Størrelse D | H mm | Passer til Snapflex | Best.-Nr. |
|-------------|------|---------------------|---------------|
| 16 + 20 | 60 | 28 | 1.505.1620.11 |
| 25 + 32 | 80 | 35 | 1.505.2532.11 |
| 40 + 50 | 100 | 55 | 1.505.4050.11 |
| 63 | 100 | 67 | 1.505.6300.11 |

➔ Montagevejledning
side 171



Snapflex

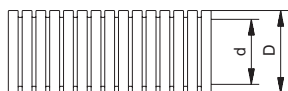

Materiale PA
 Omgivelses-temperatur -30 °C – 100 °C
 Farver grå RAL 7031
 sort RAL 9005



PP på forespørgsel

| Størrelse D | d mm | D mm | Best.-Nr. grå | Best.-Nr. sort |
|-------------|------|------|---------------|----------------|
| 16 | 10,7 | 16 | 1.510.1600.50 | 1.510.1601.50 |
| 20 | 14,1 | 20 | 1.510.2000.50 | 1.510.2001.50 |
| 25 | 18,3 | 25 | 1.510.2500.50 | 1.510.2501.50 |
| 32 | 24,3 | 32 | 1.510.3200.50 | 1.510.3201.50 |
| 40 | 31,2 | 40 | 1.510.4000.50 | 1.510.4001.50 |
| 50 | 39,6 | 50 | 1.510.5000.50 | 1.510.5001.50 |
| 63 | 50,6 | 63 | 1.510.6300.50 | 1.510.6301.50 |



Snapclip / Snapform

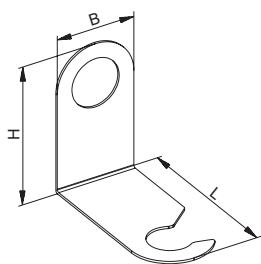
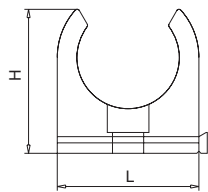

Materiale
Omgivelses-
temperatur
Farver

PA / Specialstål
-30 °C – 100 °C
grå RAL 7031
sort RAL 9005



PP på forespørgsel

| Passer til Snapflex | H mm | L mm | B mm | Best.-Nr. grå | Best.-Nr. sort |
|---------------------|------|------|------|---------------|----------------|
| Snapclip | | | | | |
| 16 | 25 | 21 | | 1.730.1600.50 | 1.730.1601.50 |
| 20 | 30 | 28 | | 1.730.2000.50 | 1.730.2001.50 |
| 25 | 34 | 34 | | 1.730.2500.50 | 1.730.2501.50 |
| 32 | 40 | 42 | | 1.730.3200.50 | 1.730.3201.50 |
| 40 | 50 | 51 | | 1.730.4000.50 | 1.730.4001.50 |
| 50 | 60 | 62 | | 1.730.5000.50 | 1.730.5001.50 |
| 63 | 72 | 76 | | 1.730.6300.50 | 1.730.6301.50 |
| Snapform | | | | | |
| 16 | 50 | 66 | 30 | | 1.318.1600.04 |
| 20 | 60 | 75 | 34 | | 1.318.2000.04 |
| 25 | 65 | 80 | 39 | | 1.318.2500.04 |
| 32 | 75 | 90 | 46 | | 1.318.3200.04 |
| 40 | 95 | 105 | 55 | | 1.318.4000.04 |
| 50 | 115 | 125 | 66 | | 1.318.5000.04 |
| 63 | 145 | 165 | 82 | | 1.318.6300.04 |

